

Level 1 Niveau 1

IEEE

International Conference on Communications 2012

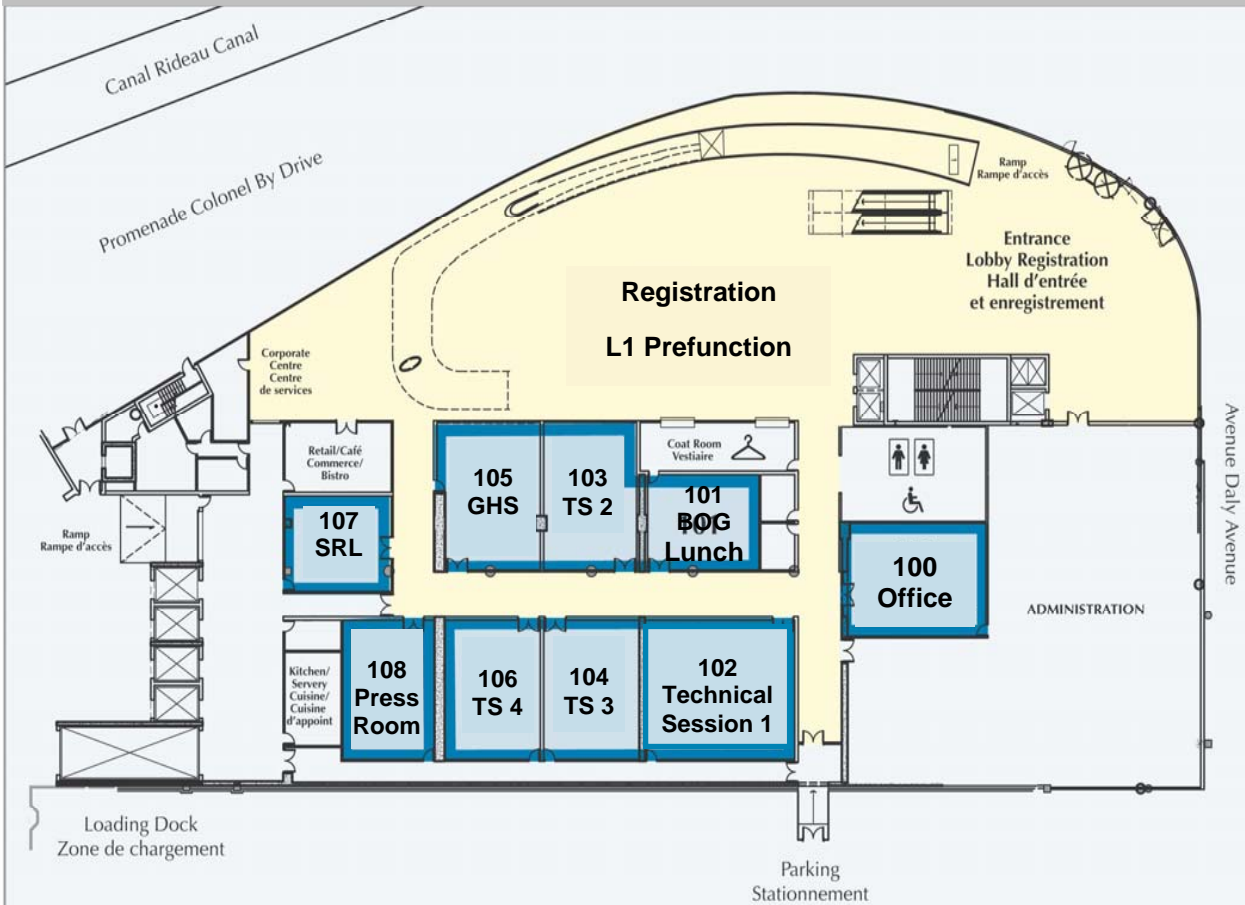

Date	Function	Room/Space	M2	Set-up max allowable
June 8 through June 15	Office	111	116	Boardroom @ 26
June 8 through June 15	Registration Set Up	L1 Prefunction	1630	
June 9 through June 14	Speaker Rehearsal Lounge (SRL)	107	75	Rounds @ 40
June 10 through June 14	Press Room	108	93	Lounge style @ 73
June 10 through June 14	Guest Hospitality Suite (GHS)	105	103	Lounge style @ 80
June 12 through June 14	Technical Session 1 (TS)	102	153	Theatre Style @ 126
June 12 through June 14	Technical Session 2 (TS)	103	102	Theatre Style @ 85
June 12 through June 14	Technical Session 3 (TS)	104	98	Theatre Style @ 80
June 12 through June 14	Technical Session 4 (TS)	106	98	Theatre Style @ 80
June 13	BOG Lunch	101	78	Rounds @ 50

Function rooms and capacities are subject to minor changes through construction.
Les salles et leur capacité sont sujettes à des changements mineurs au cours de la construction.

Level Niveau 2

IEEE International Conference on Communications 2012

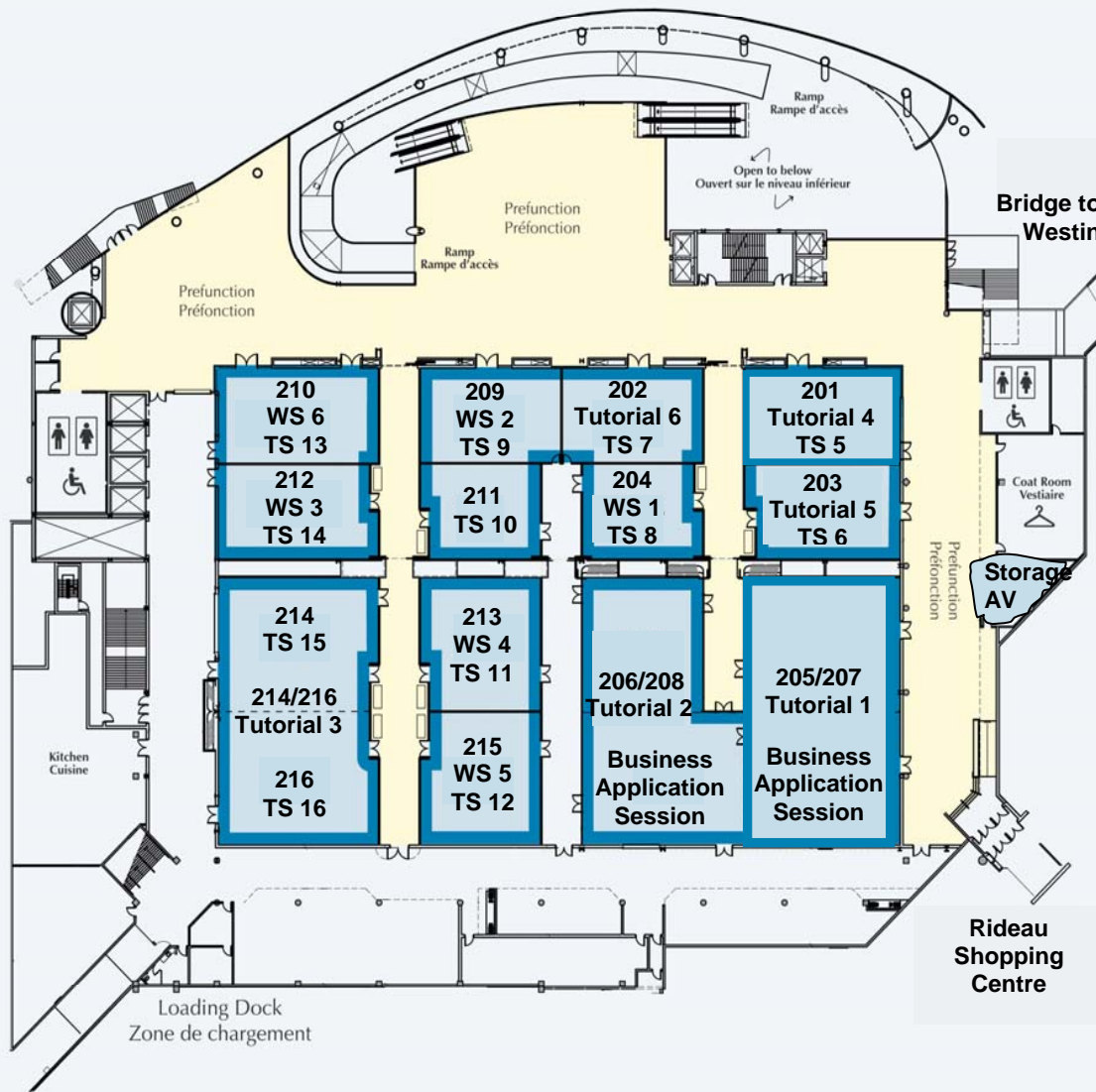

Date	Function	Space	M2	Set-up/ max allowable
June 8 through June 11	Av Storage	Show Office 3	45	
June 11 & June 15	Tutorial 1	205/207	495	Classroom Style @ 250 or Theatre Style @ 405
June 11 & June 15	Tutorial 2	206/208	512	Classroom Style @ 259 or Theatre Style @ 419
June 11 & June 15	Tutorial 3	214/216	509	Classroom Style @ 254 or Theatre Style @ 412
June 11 & June 15	Tutorial 4	201	175	Classroom Style @88
June 11 & June 15	Tutorial 5	203	175	Classroom Style @88
June 11 & June 15	Tutorial 6	202	158	Classroom Style @79
June 11 & June 15	Workshop 1 (WS)	204	136	Classroom Style @68
June 11 & June 15	Workshop 2 (WS)	209	158	Classroom Style @79
June 11 & June 15	Workshop 3 (WS)	212	180	Classroom Style @89
June 11 & June 15	Workshop 4 (WS)	213	193	Classroom Style @96
June 11 & June 15	Workshop 5 (WS)	215	193	Classroom Style @96
June 11 & June 15	Workshop 6 (WS)	210	180	Classroom Style @89
June 12 - June 14	Technical Session 5 (TS)	201	175	Theatre Style @ 142
June 12 - June 14	Technical Session 6 (TS)	203	175	Theatre Style @ 142
June 12 - June 14	Technical Session 7 (TS)	202	158	Theatre Style @ 127
June 12 - June 14	Technical Session 8 (TS)	204	136	Theatre Style @ 110
June 12 - June 14	Technical Session 9 (TS)	209	158	Theatre Style @ 127
June 12 - June 14	Technical Session 10 (TS)	211	136	Theatre Style @ 110
June 12 - June 14	Technical Session 11 (TS)	213	193	Theatre Style @ 156
June 12 - June 14	Technical Session 12 (TS)	215	193	Theatre Style @ 156
June 12 - June 14	Technical Session 13 (TS)	210	180	Theatre Style @ 145
June 12 - June 14	Technical Session 14 (TS)	212	180	Theatre Style @ 145
June 12 - June 14	Technical Session 15 (TS)	214	255	Theatre Style @ 206
June 12 - June 14	Technical Session 16 (TS)	216	255	Theatre Style @ 206
June 12 - June 14	Business Application Session	205/207	495	CS* @ 250/ TS**@405
		206/208	512	CS* @ 259/ TS**@419

Function rooms and capacities are subject to minor changes through construction.
Les salles et leur capacité sont sujettes à des changements mineurs au cours de la construction.

* = Classroom Style
** = Theatre Style

Level Niveau 3

IEEE International Conference on Communications 2012

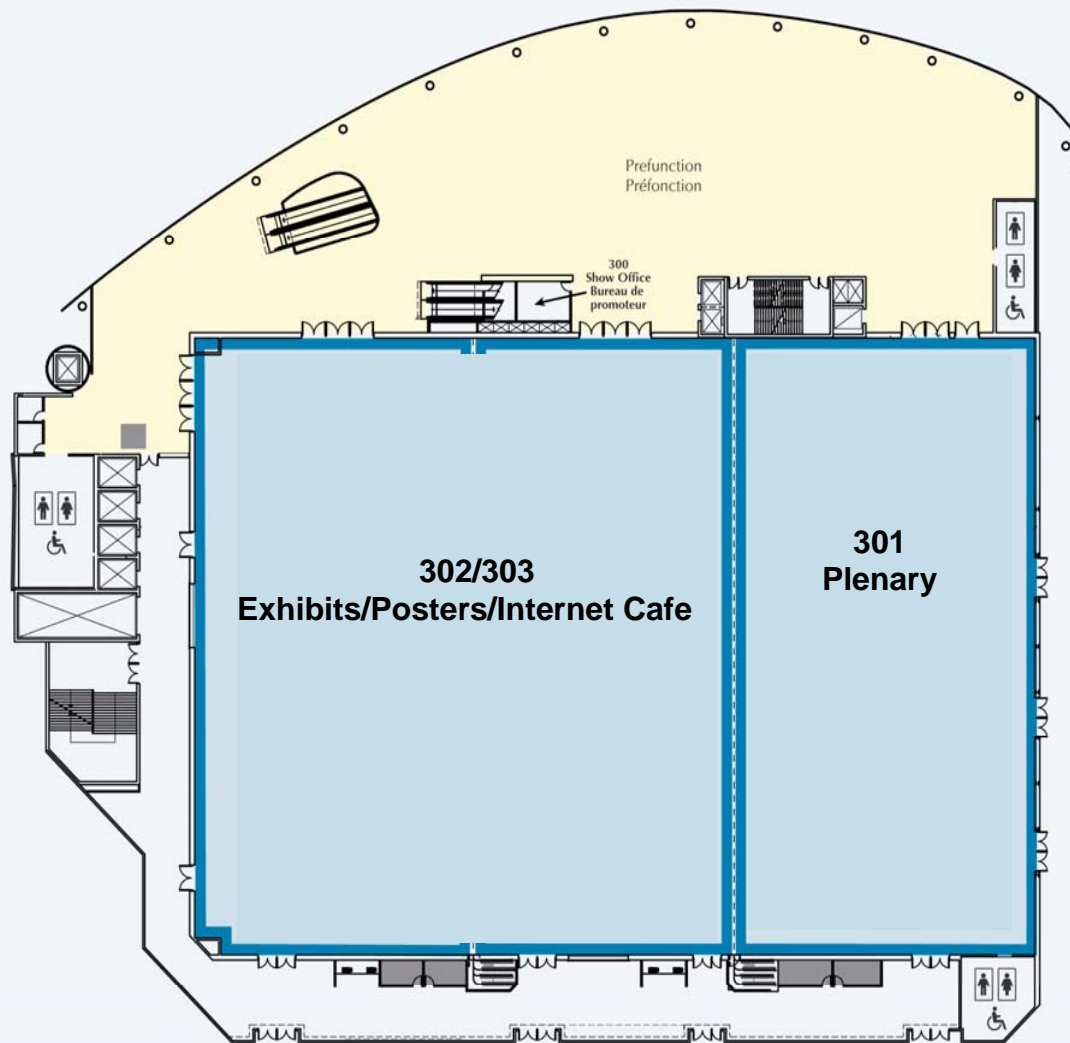

Date	Function	Space	M2	Set-up max allowable
June 10 through June 13	Exhibits/Posters/Internet Café	302/303	3360	303(3m2X3m2 booths) or 375 double-sided (2.4mX3m2) Poster Boards
June 12 through June 14	Plenary	301	1866	Theatre Style @ 1518

Function rooms and capacities are subject to minor changes through construction.
Les salles et leur capacité sont sujettes à des changements mineurs au cours de la construction.

Level 4 IEEE International Conference on Communications 2012

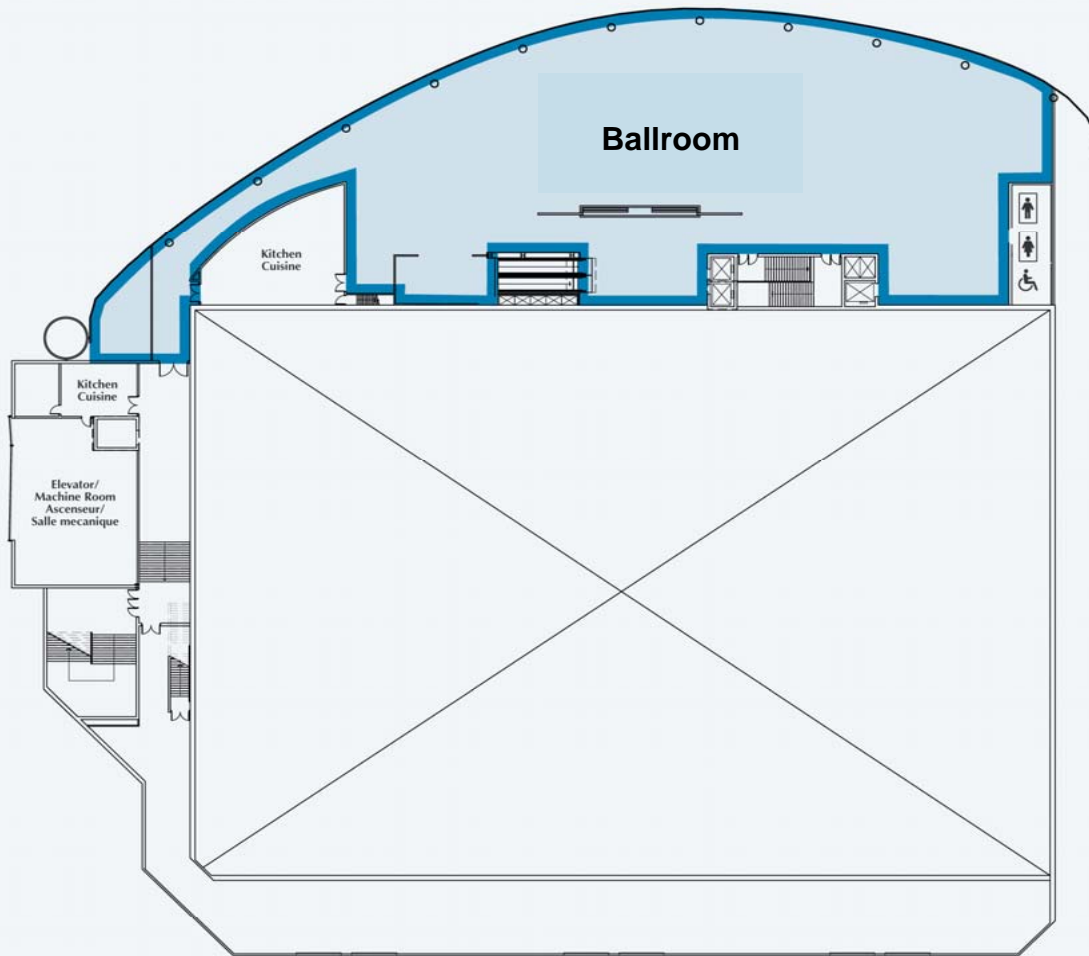

Date	Function	Space	M2	Set-up max allowable
June 11 through June 13	Speakers Breakfast	Ballroom	1770	Rounds @ 820
June 11	VIP Reception	Ballroom	1770	Lounge style @ 1038
June 12	Lunch	Ballroom	1770	Rounds @820
June 12	Reception/Banquet	Ballroom	1770	Lounge Style @ 1038
June 14 and June 15	Breaks	Ballroom	1770	Lounge style @ 1038

Function rooms and capacities are subject to minor changes through construction.
Les salles et leur capacité sont sujettes à des changements mineurs au cours de la construction.